

**RE-VOLT**

**RSX3**

**INTRODUCTION AND USER MANUAL**

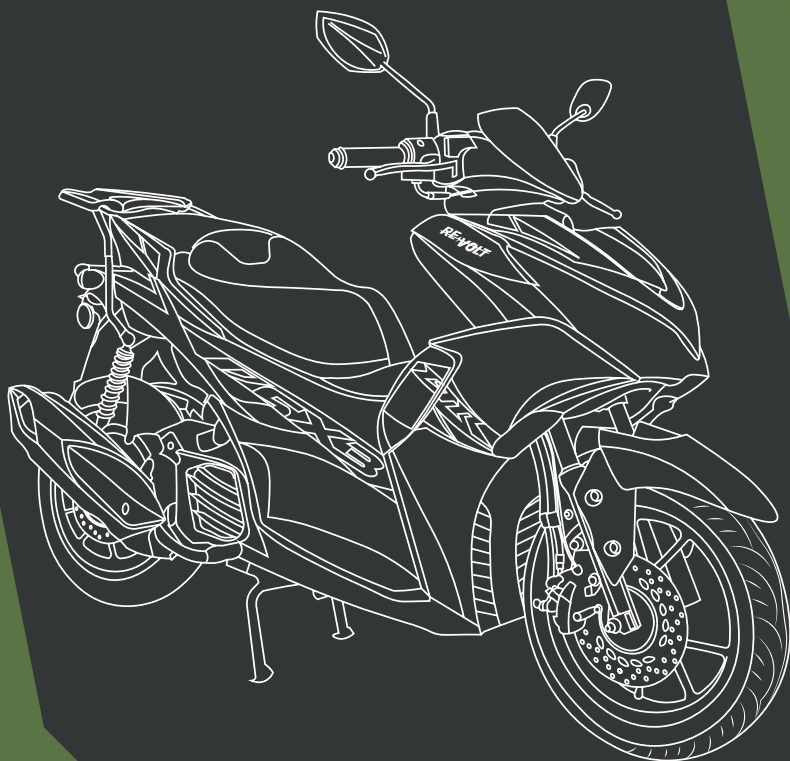

Read this owner's manual carefully  
before moving your vehicle

[www.volta.com.tr](http://www.volta.com.tr)



# PREFACE

Thank you for choosing Revolt brand motorcycle and joining our family. Our products are manufactured using high quality equipment and advanced production technologies. This vehicle is equipped with electrostatic painted steel chassis, high torque and low fuel consumption engine, exhaust system that meets European standards, a hydraulic suspension system, a reliable braking system providing short stopping distances, tires that ensure excellent road grip in all conditions, and many other components that exceed industry standards. All these features have placed Volta Motor vehicles among the top ranks in the modern world's high-quality transportation rankings. This user manual will provide you with notes, warnings, recommendations, and information on usage, adjustments, and maintenance.

Following the instructions in this manual will help your vehicle last longer and work better. Please pay close attention to safety and usage instructions.

## IMPORTANT NOTE

### Driver and Passenger

- This vehicle is designed to carry a maximum of one driver and one passenger.
- Please use your vehicle without exceeding the load limits written on the vehicle's certificate of conformity

### Road Condition

- This vehicle is designed for use on flat and asphalt roads.
- Do not use the vehicle without reading the entire user manual.
- It is recommended that you read the "Warning, Caution, Note and Safety Precautions" sections carefully



### CAUTION

- **After purchasing your vehicle, you should take it to the nearest authorized service center for its first maintenance either 1 month later or after 500 km, whichever comes first.**
- It is mandatory to adhere to the maintenance intervals specified in the user manual. Failure to do so may void the warranty. Maintenance intervals and the parts that require replacement or inspection for your vehicle are listed in this user manual.



### WARNING

- These headings are written to protect you from serious personal injury or potential accidents.



# CONTENTS

<b>Preface</b> <b>2</b>	<b>Contents</b> <b>3</b>	<b>1 Safe Driving</b> <b>4</b>
<b>2 General View</b> <b>6</b>	<b>3 Actuation And Usage</b> <b>8</b>	<b>4 Maintenance And Control</b> <b>11</b>
<b>5 Storage Conditions</b> <b>20</b>	<b>6 Technical Specifications</b> <b>22</b>	<b>7 Information Producer</b> <b>23</b>
<b>8 Guarantee</b> <b>24</b>	<b>9 Final Inspection</b> <b>25</b>	



# 1. SAFE DRIVING

## Pre-Ride Instructions

- Check the condition of all the movable parts.
- Check all rotating parts and add oil if it is missing.
- Check whether the tyres are intact.
- Check the tyre pressures
- Kornanın çalışır vaziyette olduğunu kontrol ediniz.
- Make sure that all nuts and bolts are tightened adequately.
- Check that the brake cable and other cables are not pinched and are working properly.
- Make sure the throttle is working properly.
- Check all lighting systems.

## Safe Driving Instructions

- Follow the pre-ride instructions before starting to use.
- Most accidents occur due to not being noticed in traffic. To prevent this; wear clothes that will reflect light and make you noticeable in traffic.
- Accessories such as knee pads, elbow pads, goggles, and protective gloves are protective gear that will significantly reduce your risk of serious injury. However, make sure to wear a helmet before riding your vehicle.
- Grasp the grips with both hands while riding.
- Make sure you maintain a safe driving position.
- Practice often, primarily to gain experience
- Obey the maximum loading conditions specified in the manual.
- Make sure the loads inside the bags attached to the rear carrier are light.
- Objects moving while driving will change the vehicle's center of gravity and will endanger the driving safety. Take the necessary measures to avoid this situation.
- Avoid acrobatic movements while driving your vehicle.
- Avoid high speeds when turning.
- Wet weather lengthens the braking distance and restricts maneuverability. In such cases, always maintain your low speed.
- Avoid excessive puddles that may occur in rainy weather.
- Do not use under the influence of alcohol and drugs.



# 1. SAFE DRIVING

## Efficient Driving Instructions

If the following efficient driving instructions are followed, your vehicle's driving range and efficiency will increase;

- Take your vehicle to service regularly.
- Comply with the maximum load limits in the manual.
- Be careful about using your vehicle in suitable weather and road conditions.
- Check all tyres before riding, that your tyre pressures are appropriate.
- Pay attention to the maximum speed limits.



## 2.GENERAL VIEW



- |                        |                       |
|------------------------|-----------------------|
| 1. Front Tire          | 9. Fuel Tank          |
| 2. Front Brake Disc    | 10. Seat              |
| 3. Front Brake Caliper | 11. Rear Luggage Rack |
| 4. Headlight           | 12. Stop Light        |
| 5. Brake Lever         | 13. Rear Tire         |
| 6. Dashboard           | 14. Engine            |
| 7. Mirrors             | 15. Main Stand        |
| 8. Ignition Switch     | 16. Side Stand        |

### **WARNING**

- All parts listed in the user manual are for reference. The manufacturer can make changes without notice.

### **CAUTION**

- Do not use your horn in areas where horn use is prohibited.



## 2.1. DASHBOARD



- |                             |                                |
|-----------------------------|--------------------------------|
| 1. Horn                     | 6. Start/Stop Button           |
| 2. Rear Brake Lever         | 7. Throttle Lever              |
| 3. Right/Left Signal Button | 8. Front Brake Lever           |
| 4. High/Low Beam Switch     | 9. Hazard Warning Light Button |
| 5. Dashboard                | 10. Start Button               |

### Dashboard Indicators

- |                |                         |
|----------------|-------------------------|
| a. Speedometer | b. Engine Warning Light |
| c. Fuel Gauge  | d. Rev Count            |

#### **WARNING**

- All parts listed in the user manual are provided for reference.
- The manufacturer may make changes without prior notice.



### 3. ACTUATION AND USAGE

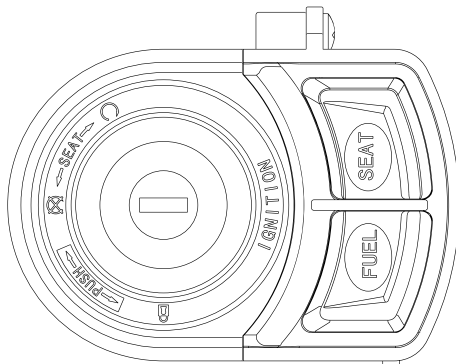

#### Turn On / Turn Off

Insert the key and turn it from the off position to the on position. The vehicle's system will activate. If you do otherwise, the system will shut down.

#### Steering Lock

Your vehicle has a steering lock feature. Turn the handlebars to the far left and press the key on the ignition lightly to turn it to the lock position. To unlock, press the key lightly to turn it to the open position and turn the handlebars in the opposite direction.

#### Seat/Fuel Tank

Without the key, the seat and fuel tank locks will not function. Insert the key into the lock and turn it to the 'SEAT' position. Then press the button for the lock you wish to open. If you close the seat/fuel tank cover, it will automatically lock.

#### Starting the Engine

Lower the vehicle from the center stand. Insert the ignition key into the slot. Squeeze the rear brake. Ensure that the side stand is closed. The engine will not start if the side stand is open. Turn the ignition key to the on position.



### 3. ACTUATION AND USAGE

- Press the starter button while twisting the throttle downward to give gas. This will start your vehicle. Repeat this process until the vehicle starts.

#### CAUTION

- In certain conditions (climate conditions, air quality, fuel flow, etc.) the engine may not start immediately. Press the engine start button for a maximum of 3 seconds each time. If it does not start for 3 seconds, wait 10 seconds and try again. If you press the engine start button for more than 3 seconds, you may burn your spark plugs. You should release the engine start button as soon as the engine starts. If you do not release it, this will damage your starter motor.

#### WARNING

- Do not move your vehicle for the first 30 seconds after starting it. During this time, the engine components will be properly lubricated. If you start moving the vehicle immediately, the engine parts may wear out due to inadequate lubrication, which will shorten the expected lifespan of your engine

#### Acceleration

Turn the throttle lever to the "A" direction as shown below and accelerate the vehicle. In this case, your vehicle will move. If you turn the throttle lever to the "B" direction, your speed and acceleration will decrease.





## 3. ACTUATION AND USAGE

### Braking

Your vehicle is equipped with a front/rear hydraulic disc brake system. The front brake is activated with the brake lever on the right, and the rear brake is activated with the brake lever on the left. Grasp the brake lever with your fingers and gently squeeze it towards you. Slowly loosen the brake lever to stop braking. Avoid sudden and hard braking. Otherwise, your vehicle may slip and cause accidents. Be careful when braking on downhill descents.

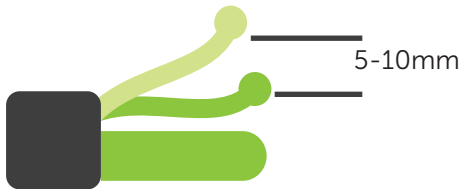

#### WARNING

- Avoid sudden and hard braking. Otherwise, your vehicle may skid and cause accidents.
- Be careful when braking downhill.
- Do not continue to accelerate while braking. This may cause damage to the electronic control unit and the engine.
- Brake pads, calipers, and brake discs can reach high temperatures during braking. Contact with these hot surfaces can cause serious injuries. Ensure that these parts have cooled down before performing maintenance or repairs.
- The disc braking system offers high braking performance. Therefore, practice braking on flat surfaces.
- The braking system can be adjusted for sensitivity. For safer deceleration, front and rear brakes should be used together.
- If the brakes are used for a long time, the brake sets heat up and their performance decreases. This can extend your braking distance and affect safe stopping.
- Brake pads should always be replaced with original products. Low-quality parts can damage other vehicle components and affect your vehicle's performance.
- The braking system is crucial for your safety. Have regular checks and adjustments performed at authorized service centers according to the intervals given in the periodic maintenance schedule.

### Loading

Do not carry loads that are not suitable for your motorcycle. Otherwise, these parts may be damaged

- The rear luggage bag can be used to carry light loads.
- Please do not exceed the allowed load limits. The maximum carrying capacity of the rear carrier is 10 kg.



## 4.MAINTENANCE AND CONTROL

### Fuel Tank

Your vehicle's fuel tank capacity is 5.5 liters. The fuel tank cap is located under the seat. After turning the key to unlock the seat, you can open the fuel tank cap by turning it by hand. If the fuel gauge needle approaches the red zone, you should refuel as soon as possible. It is recommended to use a minimum of 95 octane unleaded gasoline. If your fuel consumption is higher than expected or if the fuel level decreases even when the vehicle is not in use, please check for any leaks in the tank.

#### ! WARNING

- Ensure there are no leaks in the fuel lines.
- Check that there are no cracks, blockages, or any damage to the fuel hose.

#### ! CAUTION

- Ensure that no foreign substances like dust or water enter your vehicle's fuel tank. Pay attention to fuel quality when refueling. Poor quality fuel can damage your vehicle. Do not mix motor oil with fuel. Your engine is designed to run on unleaded gasoline only.

### Lighting Components

- The lighting system positioned at the front and rear should be used to increase visibility during both dark and daylight driving conditions. Enhancing visibility will elevate the safety level of your ride. As required by regulations, the high beam headlights will automatically turn on when the vehicle is started to increase visibility. To activate the lighting system, start the vehicle. For high beam headlights, press the high beam switch located on the left side of the panel.

### Vehicle Stands

- To keep the vehicle in a flat and stable position, there is a center stand (main stand) and a side stand (side stand). To engage the center stand, press down on the foot of the stand and gently push the vehicle backward. To retract the stand, push the vehicle forward. The side stand has a side stand sensor. This sensor prevents the vehicle from being energized when the side stand is in the open position for safety reasons. Make sure the side stand is in the retracted position before starting the vehicle.

### Batarya

- Atık akümülatörünüzün içindeki asitli sıvıyı toprağa, suya, kanalizasyona dökmeyiniz.
- Atık akümülatörünüzün plastik kısımlarını soba ve kazanlarda yakmayınız.
- Atık akümülatörleri çocuklardan uzak tutunuz.

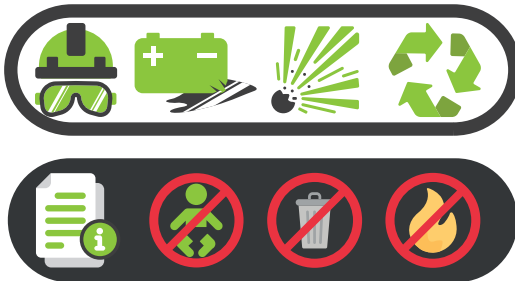



## 4.MAINTENANCE AND CONTROL

### Oil Level Check and Oil Filling

- Insert the clean oil dipstick directly into its tube.
- Remove the dipstick and check the oil level. If the oil level is at or below the lower limit, add oil until it reaches the upper limit.
- Use 10W-40 oil for the engine and 80W-90 oil for the transmission

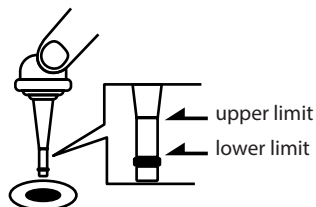

#### CAUTION

- The quality and type of oil you use are very important. Using low-quality oil directly affects the engine's lifespan. Always use oil that you are sure of in terms of quality and authenticity.
- The type of oil you use should definitely be the recommended oil.

#### WARNING

- Gasoline is highly flammable, it can explode under certain conditions. When refueling, always make sure to turn off the ignition and ensure the area is well-ventilated. Gasoline is also corrosive; Do not overfill the fuel tank as it may damage your vehicle.. Immediately after refueling, close and lock the fuel tank cap.
- Gasoline contains toxic substances that can cause harm or even death if ingested accidentally or if its fumes are inhaled in high concentrations. Avoid contact with your skin and do not inhale the fumes.

### Brake Maintenance

Brake pads wear out due to the working principle. It should be replaced when it reaches certain safety levels. Inspection of this safety level and change of pads should be done by authorized services. Unreplaced brake pads cause the brake system to work poorly, make noise, and in some cases, break other parts. Brakes should be checked at every service period.

#### CAUTION

- Brake pads should always be replaced with original parts. Low-quality components may damage other parts of the vehicle and can also affect the performance of your vehicle.

### Ignition System

You can check the ignition system by following these steps. If you detect any issues, please contact the nearest authorized service center.



# 4.MAINTENANCE AND CONTROL

Turn the key to the 'on' position.



Lift the side stand.



Pull the brake lever and press the start button.



Lower the side stand



If the engine stops: There is no issue with the side stand sensor.

## **WARNING**

- When testing the ignition system, your motorcycle should be on the center stand.

## Tire Pressure Check

Check the pressure levels of your tyres daily. Tyre pressures above and below the norm will affect the vehicle's handling, acceleration, energy consumption and similar performances.

Check your tyres daily for punctures, cuts or any other unusual condition. Also on the rims; crushing, scratching and inclination can cause pressure loss. This type of damage can cause your vehicle to unbalance and vibration. In case of such situations, please visit the nearest official service point and have the damage repaired.

	Size	LCI, Speed Index	Tyre Pressure
	90/90-12	44J, 44M, 54J	32 PSI
	3.50-10	51J, 51M, 59J, 59M	32 PSI

## **WARNING**

- If the tyre does not have the correct air pressure, it will wear out more quickly and its life will be shortened, as well deflated tyres may cause an accident as they reduce grip.
- In case of very low air pressure, the tyre may come off the rim.
- Your tyres will wear out as you use them. You should change your tyre when your tread depth decreases. Depending on the road, climate and usage conditions, your tyre life may be extended or shortened. Drivers should check tire pressure and tread depth regularly.
- Tyres with low tread depth will reduce grip, especially on wet surfaces. Minimum tread depth is 1.5 mm for front tyre, 2.0 mm for rear tyre. Such situations cause accidents.



## 4.MAINTENANCE AND CONTROL

### Air Filter Cleaning

Dirty air filter disrupts the ideal air-fuel mixture ratio and increases fuel consumption. This also leads to an increase in exhaust emissions. Regularly clean the air filter.

- Remove the air filter sponge from its box
- Clean it with a cleaning oil and let it air dry. (Do not use gasoline for cleaning!)
- Once it is completely free of cleaning oil, place it back in the plastic box.
- The air filter is made of cellulose sponge and should be checked and cleaned every 2,000 km. Clean it using a detergent solution specifically designed for this purpose and rinse thoroughly. Before use, apply a small amount of oil. Additionally, as shown in the maintenance schedule, replace it every 6,000 km.

#### CAUTION

- If your vehicle is used in rainy or dusty conditions, you should check and replace the air filter more frequently.
- Do not use gasoline for cleaning.

### Engine Oil and Transmission Oil Change

The first change of your engine oil and transmission oil should be done at 500 km. Ensure that you regularly check and change the engine oil and transmission oil according to the intervals specified in the maintenance schedule.

#### CAUTION

- If you use the vehicle under extreme conditions such as rough roads, high performance, or unusual climate conditions, increase the frequency of oil changes and checks.

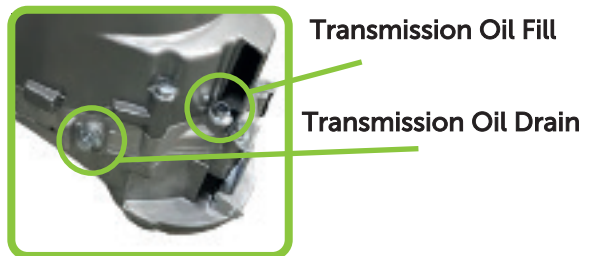

#### CAUTION

- Insufficient oil levels can lead to increased wear and potential damage to your vehicle's engine.
- Regularly check your vehicle's oil level.



## 4.MAINTENANCE AND CONTROL

### Spark Plug Inspection

Dirty spark plugs or those with an unusually high gap between the electrodes cannot ignite.

#### Bujiyi;

- Clean the spark plug with a spark plug cleaner.
- The gap between the two electrodes should be 0.6 to 0.7 mm. Adjust this gap as needed.
- Please use the spark plug recommended by the manufacturer.



#### CAUTION

- After stopping the engine, wait for the engine to cool down. Removing the spark plugs before the engine has cooled can damage your vehicle.
- First, hand-tighten the spark plug, then use a wrench to secure it.



### Fuse Replacement

The vehicle's electrical circuit is protected by a 15A glass/blade fuse. However, these fuses are single-use and need to be replaced if they blow or malfunction. For this purpose;

- Ensure that the vehicle is in the off position.
- Lift the cover located at the footrest area.
- The fuse is located in the fuse box next to the battery.
- Remove the cover of the fuse and take out the fuse.
- Replace it with a fuse of equivalent specifications.



#### CAUTION

- Do not use high-pressure water when washing your vehicle. It can damage the electrical systems.



#### WARNING

- Using a fuse with a capacity below the specified rating can cause frequent system interruptions, while using a fuse with a higher capacity can lead to damage to electronic components and wires due to excessive current.



## 4. MAINTENANCE AND CONTROL

### Assembly of the Suspension

- Lift the vehicle to the center stand. Push the rear axle back and forth by hand. If there is any play, tighten it again. Ensure that it is fully tightened and in the correct position.
- Ensure that all nuts securing the front and rear suspensions are tightened. If suspension connections are not properly tightened, some connection points may be subjected to forces beyond normal levels, which can lead to damage and potentially cause an accident.

### Adjusting the Throttle Lever

- Check that the throttle lever moves easily from the lowest to the highest position.
- The distance from the highest position to the point where the throttle responds should be between 2 and 6 mm. To adjust this, loosen the locking nut, turn the adjuster, and then tighten it again.

### Maintenance Period

- Even if your vehicle runs smoothly, it should be checked at regular intervals by going to authorized services. These intervals are specified in detail on the next pages of the user manual. Vehicles that have experienced problems or have had an accident should be taken directly to the authorized service without waiting for the maintenance interval. In such cases, repairs must be made with the original parts.
- Maintenance, repair, modification or any change that will increase the performance of the vehicle other than the contracted service stations approved by the manufacturer will cause the product to be out of warranty.



#### CAUTION

- To ensure the safety and longevity of your vehicle, please avoid modifications. Modified vehicles can jeopardize both your safety and that of others on the road. Always use parts approved by the manufacturer.



#### WARNING

- Before performing any maintenance, for your personal safety, make sure to turn off the engine and place the vehicle on its center stand. Even for simple maintenance tasks, do not perform them unless the engine is off and the vehicle is on the center stand.
- If the vehicle has not been used for 1 month or more, check components that may have worn out or rusted, such as fuel, tires, and the battery, before starting to use it again.



## 4.MAINTENANCE AND CONTROL

### Periodic Maintenance Tables

- Periodic maintenance should be done at authorized technical service stations.
- The interval between two maintenance services must not exceed 6 months or 3,000 km (whichever comes first).

#### WARRANTY MAINTENANCE CARD PERIODIC MAINTENANCE TABLE

RSX3

500 Km	3.000 Km	6.000 Km	9.000 Km	12.000 Km	15.000 Km
Kaşe Km:..... Tarih:...../...../.....	Kaşe Km:..... Tarih:...../...../.....	Kaşe Km:..... Tarih:...../...../.....	Kaşe Km:..... Tarih:...../...../.....	Kaşe Km:..... Tarih:...../...../.....	Kaşe Km:..... Tarih:...../...../.....
18.000 Km	21.000 Km	24.000 Km	27.000 Km	30.000 Km	33.000 Km
Kaşe Km:..... Tarih:...../...../.....	Kaşe Km:..... Tarih:...../...../.....	Kaşe Km:..... Tarih:...../...../.....	Kaşe Km:..... Tarih:...../...../.....	Kaşe Km:..... Tarih:...../...../.....	Kaşe Km:..... Tarih:...../...../.....
Km Saati Değişimi:		Km:..... Tarih:...../...../.....	Km:..... Tarih:...../...../.....	Km:..... Tarih:...../...../.....	Km:..... Tarih:...../...../.....



# 4.MAINTENANCE AND CONTROL

## BENZİNLİ ARAÇLAR BAKIM TABLOSU

BENZİNLİ ARAÇLAR BAKIM TABLOSU			BAKIM YAPILACAK KİLOMETRE																
PARÇA / SİSTEM ADI	PARÇA DEĞİŞİM İŞLEMLERİ*	DEĞİŞİM PERİYODU	300KM RODAJ	2.000 KM	4.000 KM	6.000 KM	8.000 KM	10.000 KM	12.000 KM	14.000 KM	16.000 KM	18.000 KM	20.000 KM	22.000 KM	24.000 KM	26.000 KM	28.000 KM	30.000 KM	6 Aylık Bakım **
Motor Yağı	Değişim.	2.000KM	●	●	●	●	●	●	●	●	●	●	●	●	●	●	●	●	●
Karter Tapa Pulu	Değişim.	2.000KM	●	●	●	●	●	●	●	●	●	●	●	●	●	●	●	●	●
Sınıman Yağı	Değişim.	4.000KM	●	●	●	●	●	●	●	●	●	●	●	●	●	●	●	●	●
Sınıman Tapa Pulu	Değişim.	4.000KM	●	●	●	●	●	●	●	●	●	●	●	●	●	●	●	●	●
Örting Motor yağı	Yağ süzgeci temizliği ve örting değişim.	6.000KM	●	●	●	●	●	●	●	●	●	●	●	●	●	●	●	●	●
Hava Filtresi	Değişim.	6.000KM	●	●	●	●	●	●	●	●	●	●	●	●	●	●	●	●	●
Üst Kapak Contası	Değişim.	4.000KM	●	●	●	●	●	●	●	●	●	●	●	●	●	●	●	●	●
Tahrik Kayıt	Değişim.	6.000KM	●	●	●	●	●	●	●	●	●	●	●	●	●	●	●	●	●
Ön Varyatör	Ağır parça değişimi, (bagaj-hayataz yüzeyleri)	6.000KM	●	●	●	●	●	●	●	●	●	●	●	●	●	●	●	●	●
Arka Debriyaj	Değişim.	10.000KM	●	●	●	●	●	●	●	●	●	●	●	●	●	●	●	●	●
Buji	Değişim.	8.000KM	●	●	●	●	●	●	●	●	●	●	●	●	●	●	●	●	●
PARÇA / SİSTEM ADI	GENEL BAKIM İŞLEMLERİ* (motor, yağ, tahrik, süzgeç, hava vs.)	BAKIM PERİYODU																	
Ön ve Arka Fren	Fren bağlantılarını kontrol edin, gerekeirse fren balatalarını değiştirin.	2.000KM	●	●	●	●	●	●	●	●	●	●	●	●	●	●	●	●	●
	Fren hortumlarında çatlak, hasar olup olmadığını kontrol edin.	2.000KM	●	●	●	●	●	●	●	●	●	●	●	●	●	●	●	●	●
	Gerekyorsa fren balatalarını değiştirin.	2.000KM	●	●	●	●	●	●	●	●	●	●	●	●	●	●	●	●	●
	Fren vidalarını kontrol edin, gerekeirse ayarlayın.	2.000KM	●	●	●	●	●	●	●	●	●	●	●	●	●	●	●	●	●
	Fren vinciğini çalıştırma kontrol edin.	2.000KM	●	●	●	●	●	●	●	●	●	●	●	●	●	●	●	●	●
	Varsa ABS sensörü bağlantılarını kontrol edin, temizleyin.	2.000KM	●	●	●	●	●	●	●	●	●	●	●	●	●	●	●	●	●
Yakıt Hortumu	Fren telli çalışmasını kontrol edin, gerekeirse ayarlayın.	2.000KM	●	●	●	●	●	●	●	●	●	●	●	●	●	●	●	●	●
	Fren diskinin kontrol edin.	2.000KM	●	●	●	●	●	●	●	●	●	●	●	●	●	●	●	●	●
	Yakıt hortumlarında çatlak, sızıntı olup olmadığını kontrol edin.	2.000KM	●	●	●	●	●	●	●	●	●	●	●	●	●	●	●	●	●
	Motor, egzoz, fren (mekanik), kadroya ark çubuğu, somun, vida bağlantılarını kontrol edin, gerekli bağlantıları sıkın.	2.000KM	●	●	●	●	●	●	●	●	●	●	●	●	●	●	●	●	●
Aydınlatma Elemanları	Far, arka stop, sinyaller ve düğmelerin çalışmasını kontrol edin.	2.000KM	●	●	●	●	●	●	●	●	●	●	●	●	●	●	●	●	●
Enjeksiyon	Motor rotarı devrini kontrol edin.	2.000KM	●	●	●	●	●	●	●	●	●	●	●	●	●	●	●	●	●
Egzoz	Temizleyin.	4.000KM	●	●	●	●	●	●	●	●	●	●	●	●	●	●	●	●	●
Aks	Temiz olup olmadığını kontrol edin, gerekeirse siler veya contalarını değiştirin.	2.000KM	●	●	●	●	●	●	●	●	●	●	●	●	●	●	●	●	●
	Aks voltajını ölçün, gerekeirse tam şarj edin veya değiştirin.	2.000KM	●	●	●	●	●	●	●	●	●	●	●	●	●	●	●	●	●
Lastikler	Kıtlap basıncının sıkışmasını kontrol edin.	2.000KM	●	●	●	●	●	●	●	●	●	●	●	●	●	●	●	●	●
	Lastiklerin birinci ve ikinci tarafında hasar olup olmadığını ve ölç derinliğini kontrol edin.	2.000KM	●	●	●	●	●	●	●	●	●	●	●	●	●	●	●	●	●
Zantlar	Zantı veya hasar olup olmadığını kontrol edin.	2.000KM	●	●	●	●	●	●	●	●	●	●	●	●	●	●	●	●	●
Tekerlek Rulmanları	Çözümler boşluk olmadığını ve tekerleklerin rahat döndüğünü kontrol edin.	2.000KM	●	●	●	●	●	●	●	●	●	●	●	●	●	●	●	●	●
Gidon Rulmanları	Gidon rulmanlarını aşınma, veya gevşek olup olmadığını kontrol edin, gerekeirse yağlayın.	2.000KM	●	●	●	●	●	●	●	●	●	●	●	●	●	●	●	●	●
Ön Süspansiyon	Yaylarını kontrol edin, Amortisör (b) kontrolünde çök, hasar veya aşınma olup olmadığını kontrol edin.	2.000KM	●	●	●	●	●	●	●	●	●	●	●	●	●	●	●	●	●
Arka Süspansiyon	Çalışırken alaraz edici bir ses çıkmadığını ve yağ kaçağı olup olmadığını kontrol edin.	2.000KM	●	●	●	●	●	●	●	●	●	●	●	●	●	●	●	●	●
Gaz Kolu	Çalışırken ve gaz kolu boşluğunu kontrol edin, gerekeirse ayarlayın.	2.000KM	●	●	●	●	●	●	●	●	●	●	●	●	●	●	●	●	●
Buj	Gaz tetini çalışmasını kontrol edin, gerekeirse yağlayın.	2.000KM	●	●	●	●	●	●	●	●	●	●	●	●	●	●	●	●	●
	Buj durumunu kontrol edin, temizleyin ve gerekeirse buji boşluğunu ayarlayın.	2.000KM	●	●	●	●	●	●	●	●	●	●	●	●	●	●	●	●	●
Supap	Buj boşluğunu kontrol edin, temizleyin ve gerekeirse buji boşluğunu ayarlayın.	2.000KM	●	●	●	●	●	●	●	●	●	●	●	●	●	●	●	●	●
	Buj boşluğunu kontrol edin, temizleyin ve gerekeirse buji boşluğunu ayarlayın.	2.000KM	●	●	●	●	●	●	●	●	●	●	●	●	●	●	●	●	●
Motor Yağı	Yağ seviyesini ve motorda yağ seviyesi olup olmadığını kontrol edin.	2.000KM	●	●	●	●	●	●	●	●	●	●	●	●	●	●	●	●	●
Motor Yağı Süzgeci	Yağ süzgecini temizleyin.	6.000KM	●	●	●	●	●	●	●	●	●	●	●	●	●	●	●	●	●
Hava Filtresi	Temizleyin.	2.000KM	●	●	●	●	●	●	●	●	●	●	●	●	●	●	●	●	●
Yakıt Filtresi	Temizleyin.	6.000KM	●	●	●	●	●	●	●	●	●	●	●	●	●	●	●	●	●
Ön Varyatör	Bagaj ve kaydırıcı yüzeylerde aşınma olup olmadığını kontrol edin, gerekeirse değiştirin.	2.000KM	●	●	●	●	●	●	●	●	●	●	●	●	●	●	●	●	●
Arka Debriyaj	Temizleyin.	2.000KM	●	●	●	●	●	●	●	●	●	●	●	●	●	●	●	●	●
	Debriyaj hatlarında aşınma olup olmadığını kontrol edin, gerekeirse değiştirin.	2.000KM	●	●	●	●	●	●	●	●	●	●	●	●	●	●	●	●	●
Tahrik Kayıt	Temizleyin.	2.000KM	●	●	●	●	●	●	●	●	●	●	●	●	●	●	●	●	●
	Tahrik kaydırıcı çatlak veya aşınma olup olmadığını kontrol edin, gerekeirse değiştirin.	2.000KM	●	●	●	●	●	●	●	●	●	●	●	●	●	●	●	●	●

\*Garanti süresi, garanti belgesi yönetmeliği uyarınca, malın tüketiciye teslim tarihinden itibaren başlar ve motosikletler ve ATV araçlar için 2 yıl veya 30.000km (hangisi önce dolarsa), diğer araçlar (e-bike, elektrikli kayak, elektrikli motorlu bisiklet vb.) için 2 yıldır.

\*\* Yukarıda değişim periyodu verilen parçaların çalışma süresi boyunca sürümüne, ısı ve mekanik stress nedeniyle zamanla doğal olarak aşınmaktadır, Bu nedenle bakım kilometresi geldiğinde mutlaka değiştirilmesi önerilir. Değiştirilmeden önce parçaları ve bu parçalardan kaynaklanan arızalar da garanti kapsamı içerisinde değerlendirilmir.

\*\* İki bakım arası süre 6 ayı geçmemelidir. Km bazında bakım yapılmıyorsa, 6 aylık bakım yapılmalıdır.

VOLTA MOTOR SANTIÇAŞ  
Merkez Mah. Yıldıztepe Cad. Gümüşova OSB  
Gümüşova / DÜZCE

VOLTA

RE-VOLT

VTA

0380 731 25 25 0380 731 25 35  
info@volta.com.tr



## 4. MAINTENANCE AND CONTROL

### First Use (Running-in)

- Do not push the vehicle during the running-in period. The running-in period of your vehicle is the time until the first maintenance.
- The initial use is the phase where the parts of your gasoline motorcycle adjust to each other. During this phase, please avoid stressing your gasoline motorcycle.
- Avoid sudden acceleration. Do not fully twist the throttle during the running-in period. Engine components adjust to each other at maximum performance at low revs.
- Do not start riding immediately after starting your motorcycle. Wait for a while while the motorcycle is idling to allow the engine oil to reach all engine components.
- Do not carry loads or passengers during the running-in period.

### First Maintenance

- The first 500-1,000 km maintenance is crucial for your vehicle. After initial use, the engine components will have adapted to each other, and it is recommended to check all bolts and change the engine oil during the first maintenance.
- With the first maintenance, the engine and motorcycle components will begin to work in harmony and parts will settle into place with use. Therefore, all component bolts and nuts will be tightened, and the engine oil will be replaced with new oil.
- The reliability of your vehicle depends on a properly conducted initial use and the first periodic maintenance.

### MOTOR CODE AND CHASSIS NUMBER

Motor code and chassis number are for the registration of your vehicle and help our authorized services in order to provide better service to you in case of need for maintenance / repair.

#### CAUTION

- Make sure that the motor and chassis numbers on your electric vehicle are the same as those on the certificate of conformity.



Motor Code



Vehicle Identification



## 5.STORAGE CONDITIONS

### Storage

If you are not going to use your vehicle for a long time during periods such as winter , you should take some precautions to protect your vehicle from malfunctions and corrosions. It would be better to make some repairs before storage.

- Check the engine oil and replace it if necessary.
- Drain all the fuel from the fuel tank and carburetor. Clean with rust remover oil and then securely close the fuel tank cap. Do not smoke or play with fire while draining the tank.
- Remove the spark plug and pour a spoonful of engine oil into the cylinder. Run the engine for a few minutes. After the oil has fully coated the cylinder, reinstall the spark plug.
- Remove your battery. Store it at room temperature in a place that is not exposed to direct sunlight (20-25°C is ideal). Charge the battery at least once a month
- Clean, rinse and dry your vehicle. Coating the painted surfaces with protective oil will extend the life of your paint and ensure that it retains its first day's shine.
- Bring the tire pressure of your electric vehicle to the ideal level. Raise the vehicle onto the center stand and place wooden blocks under the front and rear wheels to lift them off the ground.
- Cover with a non-plastic or non-rubber cover. Ensure that the storage conditions avoid significant temperature fluctuations. High temperature changes can cause many parts of your vehicle to fatigue, degrade, or crack.

### Putting the motorcycle back into use

- Remove the cover from your vehicle and clean it.
- If you have not used the vehicle for more than 4 months, change the engine oil.
- Check the battery fluid level and top it up if necessary. Reconnect the battery.
- Empty the fuel tank of rust remover oil and refill it with gasoline.
- Start the vehicle after completing all pre-driving instructions.
- Perform the initial operation in a traffic-free area. Only enter traffic after ensuring that all components of the vehicle are operating correctly and at full performance.



## 5.STORAGE CONDITIONS

- All loads on the vehicle must be evenly distributed. The vehicle's center of gravity is precisely adjusted. Disruption of this balance may cause instability, leading to accidents or damage.
- The rear carrier is designed only for carrying light items. Please do not carry heavy items.
- When calculating your vehicle's carrying capacity, add up all the loads being carried. This includes the driver, passenger, and all carried items.
- Overloading the vehicle will make it harder to handle and shorten its lifespan. Please do not exceed the load limits specified in your technical documentation.

### **Transport**

When transporting your gasoline motorcycle, make sure the ignition is off. Engage the front and rear brakes. To prevent any external damage to your vehicle, you can safely transport it by covering a metal cage with cardboard.

### **Assembly**

The gasoline motorcycle is delivered assembled.



## 6. TECHNICAL SPECIFICATIONS

Parameters	
Length	1966 mm
Width	755 mm
Height	1138 mm
Wheelbase	1332 mm
Weight	120 kg
Max Carrying Capacity	150 kg
Engine Capacity	124.6 cm <sup>3</sup>
Max Net Power	8.91 PS
Max Net Torque	8.5 Nm
Cylinder Number	1
Cylinder Arrangement	S
Bore/Diameter	52.4 MM
Stroke	57.8 MM
Compression Ratio	9.3:1
Transmission Type	CVT
Max Speed	85 KM/H
Fuel Consumption	2.7 L/ 100 KM
Fuel Tank Capacity	8.34 LT
Battery	/
Front Brake	230 MM HYDR. DISC
Rear Brake	220 MM HYDR. DISC
Seat Position Number	2
Tyres	
Size	100/80-14
Load,Index Pressure	/
Size	/
Load,Index Pressure	120/70-14
	/
	/



## 7. MANUFACTURER INFORMATION

The service life of your Volta brand vehicle is 10 years, and the maximum repair period is 45 working days. If you encounter any problems with your vehicle, you can visit our website [www.volta.com.tr](http://www.volta.com.tr) and access information about authorized services and spare parts.

You can access all authorized service station information from the Service Information System created by the Ministry.

### **VOLTA MOTOR SANAYİ VE TİCARET A.Ş.**

Selamlar Köyü Selamlar Mevkii Gümüşova OSB 1.Sokak Blok No:10

**Gümüşova / DÜZCE / TÜRKİYE**

Tel : 0850 222 28 65

[info@volta.com.tr](mailto:info@volta.com.tr)

### **VOLTA MOTOR SERBEST BÖLGE**

Tübitak Teknoloji Serbest Bölgesi Tübitak MAM Teknoloji Serbest Bölgesi

Barış SB. Mh. 5001 Sk. No:3 A/B

**Gebze / KOCAELİ / TÜRKİYE**

Tel : 0850 222 28 65

[info@volta.com.tr](mailto:info@volta.com.tr)

### **VOLTA MOTOR SAN. VE TIC. A.Ş**

Adres: Yaka Mah. 401 Sok. No:19 Cumayeri/Düzce/TÜRKİYE

**Cumayeri/Düzce/TÜRKİYE**

Tel : 0850 222 28 65

[info@volta.com.tr](mailto:info@volta.com.tr)



## MANUFACTURER

Trade Name	Volta Motor Sanayi ve Tic. A.Ş.		
Address	<b>Volta Motor Sanayi ve Ticaret A.Ş.</b> Selamlar Köyü Selamlar Mevkii Gümüşova OSB 1.Sokak Blok No:10 <b>Gümüşova / DÜZCE / TÜRKİYE</b> Tel : 0850 222 28 65 info@volta.com.tr	<b>VOLTA MOTOR CUMAYERİ</b> Yaka Mah. 401. Sok. No: 19 <b>Cumayeri / DÜZCE</b> Tel : 0850 222 28 65 info@volta.com.tr	<b>VOLTA MOTOR SERBEST BÖLGE</b> Tübitak Teknoloji Serbest Bölgesi Tübitak MAM Teknoloji Serbest Bölgesi Barış SB. Mh. 5001 Sk. No:3 A/B <b>Gebze / KOCAELİ / TÜRKİYE</b> Tel : 0850 222 28 65 info@volta.com.tr
Phone	+90 850 222 28 65	+90 850 222 28 65	
Fax	+90 850 222 28 65	+90 850 222 28 65	

## PRODUCT

Type	Gasoline Vehicle
Commercial Name	Revolt
Model	RSX3
VIN	
Delivery Date and Place	
Maximum Repair Time	45 Working Days
Warranty Period	2-Year

## SELLER

Trade Name	
Address	
Phone	
Fax	
Invoice Date and Number	
Date of Sale	

This section must be filled in completely by the seller. (Stamp and Signature)



## 9.SON KONTROL

### Pre-Delivery Checks;

1. No short circuit in the electrical system
2. No shipping damage to the vehicle
3. Battery charge is complete
4. Wheel/tyre movements are normal, no imbalance
5. Chassis and engine numbers have been checked
6. Engine oil level is normal
7. Tire pressures are normal
8. Engine mounting bolts are tightened
9. Throttle cable adjustment is normal
10. Throttle butterfly body bolts are tightened
11. Engine operation is normal
12. No noise or rumble from bearings and gears
13. Headlight controls are functioning properly
14. Headlights and parking lights are operational
15. Rear lights and brake lights are operational
16. Fuel gauge is working
17. Oil warning light is functioning correctly
18. Turn signals (flashers) are working
19. Control buttons are functioning
20. Start button is working

### Road Test

21. Vehicle traction is good
22. No imbalance or pulling during driving
23. Brake checks have been performed
24. Vibration and shaking are normal
25. Speed/RPM indicators are functioning

### To Be Explained To The End User

Please check the boxes below.

**A**-Has the motorcycle owner been instructed on how to start the engine?

**B**-Has the motorcycle owner been informed about the type of fuel to be used?

**C**-Has the motorcycle owner been provided information about the warranty and the necessary actions they need to take?

**D**-Has the motorcycle owner been advised not to push the engine to high RPMs during the break-in period (500 km)?

**E**-Has the motorcycle owner been informed that the engine oil should be changed every 6 months, even if the maintenance mileage hasn't been reached?

**F**-Has the motorcycle owner been advised that the engine oil should be checked every 1,000 km?

**G**-Has the motorcycle owner been instructed on the contents of the user manual and advised to read it?

--

--

--

--

--

--

--

### ARAÇ SAHİBİ

ADI - SOYADI:

TELFON:

İMZA:



You can go to the web address where you can search for the nearest



**SERVICE**

You can go to the web address where you can search for the nearest



**SALES**



# GASOLINE VEHICLE MAINTENANCE TABLE

## GASOLINE VEHICLE MAINTENANCE TABLE

## MAINTENANCE MILEAGE

PART/SYSTEM NAME	PART REPLACEMENT PROCEDURES	Replacement Interval	500 KM (1 Month) (Break-In)	1,000 KM (6 Months)	6,000 KM (24 Months)	9,000 KM (36 Months)	12,000 KM (48 Months)	15,000 KM (60 Months)	18,000 KM (72 Months)	21,000 KM (84 Months)	24,000 KM (96 Months)	27,000 KM (108 Months)	30,000 KM (120 Months)	33,000 KM (132 Months)	36,000 KM (144 Months)	39,000 KM (156 Months)	42,000 KM (168 Months)	45,000 KM (180 Months)	6 Month* Maintenance
Engine Oil	Replacement	3,000KM																	
Transmission drain plug washer	Replacement	3,000KM																	
O-ring (Motor yag sigortası)	Oil filter cleaning and O-ring replacement.	6,000KM																	
Air Filter	Replacement	6,000KM																	
Valve Cover Gasket	Replacement	3,000KM																	
Drive Belt	Replacement	6,000KM																	
Front Variator	Worn Parts Replacement (bushings + sliding surfaces)	6,000KM																	
Rear Clutch	Replacement	9,000KM																	
Spark Plug	Replacement	6,000KM																	

PART/SYSTEM NAME	GENERAL MAINTENANCE PROCEDURES* (Inspection, adjustment, cleaning, lubrication, tightening, etc.)	Maintenance Period	500 KM (1 Month) (Break-In)	1,000 KM (6 Months)	6,000 KM (24 Months)	9,000 KM (36 Months)	12,000 KM (48 Months)	15,000 KM (60 Months)	18,000 KM (72 Months)	21,000 KM (84 Months)	24,000 KM (96 Months)	27,000 KM (108 Months)	30,000 KM (120 Months)	33,000 KM (132 Months)	36,000 KM (144 Months)	39,000 KM (156 Months)	42,000 KM (168 Months)	45,000 KM (180 Months)	6 Month* Maintenance
Front and Rear Brakes	Check the brake connections, inspect their operation, the level of hydraulic fluid, and whether there are any leaks in the system.	3,000KM																	
	Check for cracks or damage in the brake hoses	3,000KM																	
	Replace the brake pads if necessary.	3,000KM																	
	Check the brake lever, Adjust if necessary.	3,000KM																	
	Check the operation of the brake switches.	3,000KM																	
	If applicable, check and clean the ABS sensor connections	3,000KM																	
	Check the operation of the brake cable and lubricate if necessary.	3,000KM																	
Fuel Hose	Check the brake discs.	3,000KM																	
	Check the fuel hoses for cracks or leaks.	3,000KM																	
Fasteners	Check the bolts, nuts, and screws on the engine, exhaust, brake hubs, and frame. Tighten any loose connections.	3,000KM																	
Lighting Components	Check the operation of the headlights, taillight, turn signals, and buttons	3,000KM																	
Injection	Check the engine idle speed.	3,000KM																	
Exhaust	Measure the battery voltage. Charge or replace it if necessary.	6,000KM																	
	Check for leaks. Tighten or replace gaskets if necessary.	3,000KM																	
Battery	Measure the battery voltage. Charge or replace it if necessary.	3,000KM																	
	Check the tightness of the battery terminals.	3,000KM																	
Tires	Check the tire pressure. Inspect the treads for damage, and measure the tread depth.	3,000KM																	
Blinds	Check for leaks or damage.	3,000KM																	
Wheel Bearings	Check for any play in the hub and ensure the wheels turn freely	3,000KM																	
Steering Bearings	Check the handlebars' bearings for wear or looseness. Lubricate if necessary.	3,000KM																	
Front Suspension	Check the suspension for proper movement. Inspect the shock absorbers' inner tubes for scratches, damage, or excessive lubrication	3,000KM																	
Rear Suspension	Check for any unusual noises while operating and inspect for oil leaks.	3,000KM																	
	Check the operation and throttle play, and adjust if necessary.	3,000KM																	
Throttle	Check the throttle cable operation and lubricate if necessary.	3,000KM																	
	Check the condition of the spark plug. Clean it and adjust the spark plug gap if necessary.	3,000KM																	
Spark Plug	Ensure the spark plug cap is properly seated and free of cracks.	3,000KM																	
		3,000KM																	
Valve	Check the valve clearance and adjust if necessary.	3,000KM																	
Engine Oil	Check the oil level and inspect the engine for any oil leaks.	3,000KM																	
Engine Oil Filter	Clean the oil filter.	6,000KM																	
Air Filter	Clean it.	3,000KM																	
Fuel Filter	Clean it.	6,000KM																	
Front Variator	Check the wear on the bag and slider surfaces, and replace if necessary.	3,000KM																	
	Clean it.	3,000KM																	
Rear Clutch	Check the clutch plate for wear and replace it if necessary.	3,000KM																	
	Clean it.	3,000KM																	
Drive Belt	Check the drive belt for cracks or wear, and replace it if necessary.	3,000KM																	

\* The warranty period for Volta Motor vehicles is 1 year. You can contact our authorized dealer/service center in your country for warranty terms.

\* The components listed above, which have specified replacement intervals, naturally wear out over time due to friction, thermal, and mechanical stress during operation. Therefore, it is strongly recommended to replace them when the maintenance mileage is reached. Components that are not replaced and any faults arising from these components are not covered under warranty.

\* The interval between two maintenance periods should not exceed 6 months. If maintenance has not been performed based on mileage, a 6-month maintenance should be carried out.



NOTLAR



NOTLAR



# REVOLT

[www.volta.com.tr](http://www.volta.com.tr)

## DÜZCE/TÜRKİYE

📍 Selamlar Koyu, Selamlar Mevkii,  
Gumusova OSB 1. Sk. No:10  
Gumusova/DUZCE/TURKEY

☎ 0850 222 28 65  
✉ [info@volta.com.tr](mailto:info@volta.com.tr)

## DÜZCE/TÜRKİYE

📍 Yaka Mah. 401 Sk. No:19  
Cumayeri/Düzce/TÜRKİYE

☎ 0850 222 28 65  
✉ [info@volta.com.tr](mailto:info@volta.com.tr)

## GEBZE/TURKIYE

📍 Tubitak MAM Teknoloji Serbest Bölgesi  
Baris SB. Mh. 5001 Sk. No:3 A/B  
Gebze/KOCAELI /TURKEY

☎ 0850 222 28 65  
✉ [info@volta.com.tr](mailto:info@volta.com.tr)